

Square Wafers (Inch)

Screw Size	Part Number	A/F inch/mm	L inch/mm	OD inch/mm
10	SQWI-10	.190/4.83	.115/2.92	.671/17.04
1/4	SQWI-14	.249/6.32	.146/3.71	.671/17.04
5/16	SQWI-31	.310/7.87	.177/4.50	.875/22.23
3/8	SQWI-37	.380/9.65	.290/7.37	.875/22.23

Square Wafers Metric (DIN 603)

Screw Size	Part Number	A/F inch/mm	L inch/mm	OD inch/mm
M5	SQWM-M5	.193/4.90	.138/3.51	.875/22.23
M6	SQWM-M6	.232/5.89	.158/4.01	.875/22.23
M8	SQWM-M8	.310/7.87	.197/5.00	.875/22.23
M10	SQWM-M10	.380/9.65	.236/5.99	1.125/28.58
M12	SQWM-M12	.457/11.61	.315/8.00	1.250/31.75

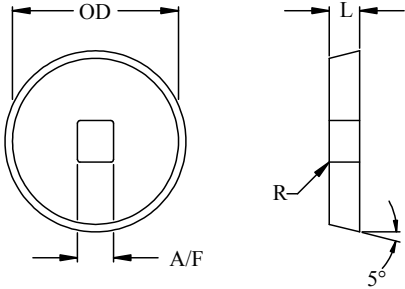

Fillister Wafers

Screw Size	Part Number	ID inch/mm	L inch/mm	OD inch/mm
1	FWI-1	.111/2.82	.042/1.07	.445/11.30
2	FWI-2	.132/3.35	.048/1.22	.445/11.30
3	FWI-3	.153/3.89	.057/1.45	.445/11.30
4	FWI-4	.174/4.42	.065/1.65	.445/11.30
4	FWI-4-1	.174/4.42	.065/1.65	.671/17.04
5	FWI-5	.196/4.98	.074/1.88	.671/17.04
5	FWI-5-1	.196/4.98	.074/1.88	.671/17.04
6	FWI-6	.217/5.51	.082/2.08	.445/11.30
6	FWI-6-1	.217/5.51	.082/2.08	.671/17.04
7	FWI-7	.238/6.05	.090/2.29	.671/17.04
8	FWI-8	.260/6.60	.098/2.49	.671/17.04
10	FWI-10	.302/7.67	.114/2.90	.671/17.04
10	FWI-10-1	.302/7.67	.114/2.90	.875/22.23
12	FWI-12	.345/8.76	.128/3.25	.671/17.04
1/4	FWI-14	.400/10.16	.149/3.78	.671/17.04
1/4	FWI-14-1	.400/10.16	.149/3.78	.875/22.23
5/16	FWI-31	.504/12.80	.186/4.72	.875/22.23
3/8	FWI-37	.606/15.39	.227/5.77	.875/22.23

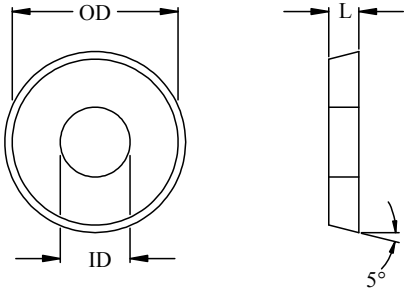

1. M-2 Material at 58-60 RC.
2. Special materials available upon request.
3. PVD Coatings available.